



BLACK UNICORN CRANE

Gyrostabilized remotely-controlled **Black Unicorn Crane** is designed to solve a huge range of complex operator's tasks when shooting stationary and moving objects. It allows to increase the dynamics and add drama to any scene. High precision and ease of use, combined with powerful characteristics, significantly expands the technical capabilities of filming.

Remotely controlled **Black Unicorn Crane** can operate with any panoramic gyrostabilized camera platforms: from tiny to gigantic, weighing more than 85kg. Light and agile **Black Unicorn Crane** allows shooting at a carrier speed of over 180 km/h and 90 km/h off-road. Remote control of the crane is carried out from the cabin of the vehicle. Black Unicorn Crane is not difficult to uninstall from the roof of the car and to install on other vehicles of various types, for example, on a boat or a train.



ESPECIFICACIONES TECNICAS

GIROESTABILIZED PAN AND TILT

Different Arms Configurations: 3.15 MTS, 4.25 MTS, 5.35 MTS, 6.45 m, 7.55 MTS

Arm Turning: 360° continuous

Tilt Operating Angle: + 42°, -29°

Maximum Arm Range: + 62°, -62°

Pan Speed 360° /4.5 SECONDS

Maximum Load Weight: 85 KG.

Adjustable Counterfeit: + - 0,3 MTS:

Time Seting Counterweighth: 10 Seconds

Nominal Voltage: 60 VDC

Weather Protection: IP65 Water-proof

Maximum Weight with Maximum Load Capacity: 790 KG

Total Weight without Contrapese Standard Configuration: 275 KG.

Programmable Safety Limits

Maximum Road Operation Speed: Up than 180 KM/H

Optional Maximum off Road Speed: 90 KM/H

CONFIGURACION 1

3,15 MTS. 10FT.4"

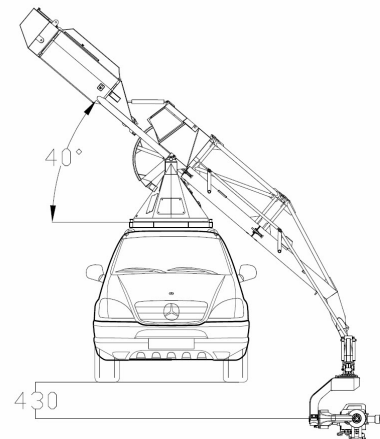
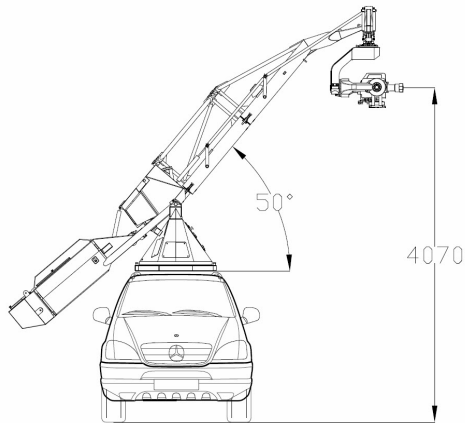
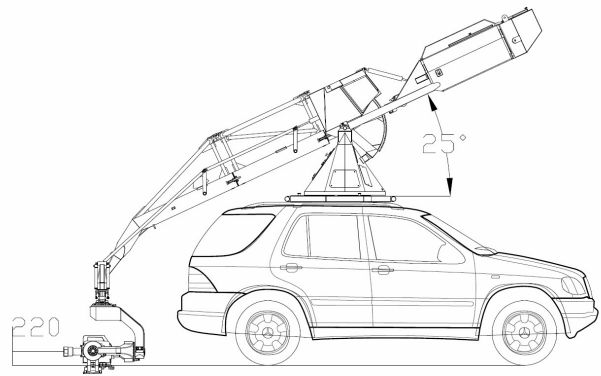
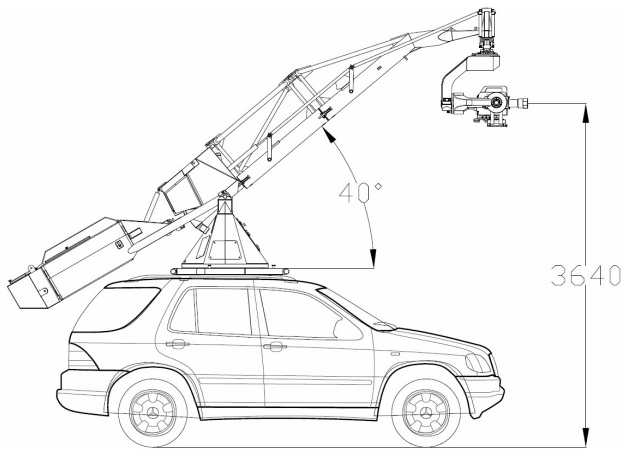

CONFIGURACION 2

4,25 MTS 13FT 11"

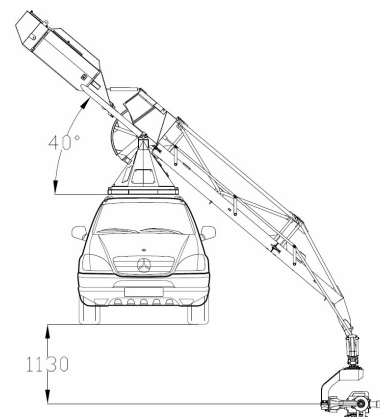
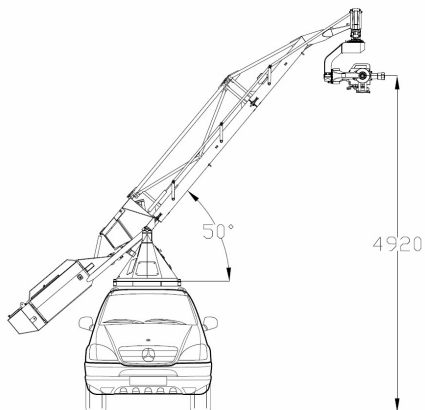
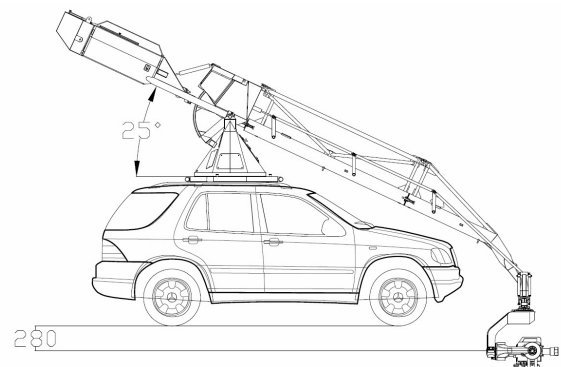
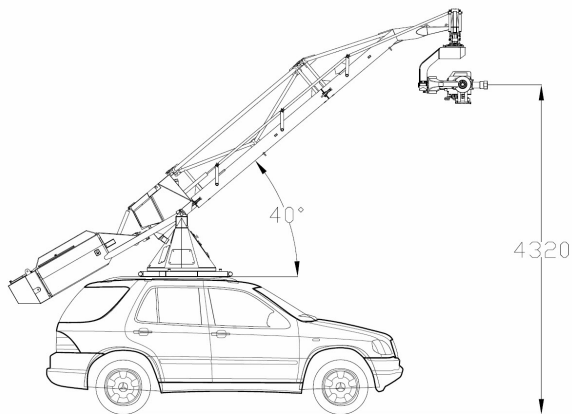

CONFIGURACION 3

5,35 MTS 17FT 7"

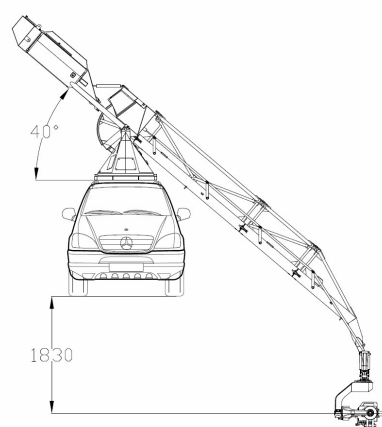
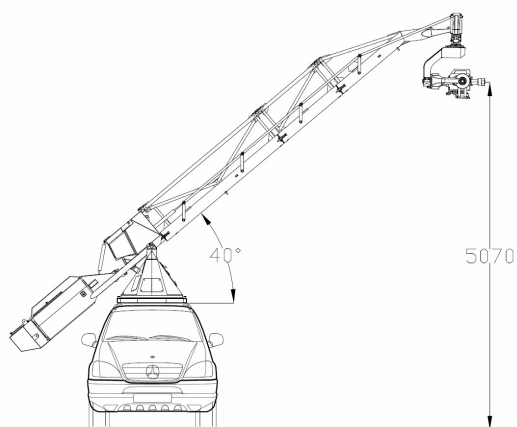
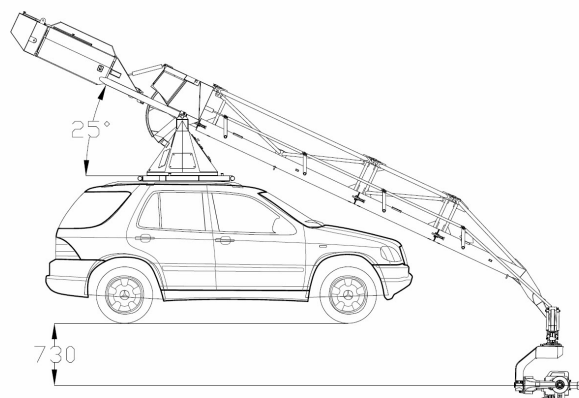
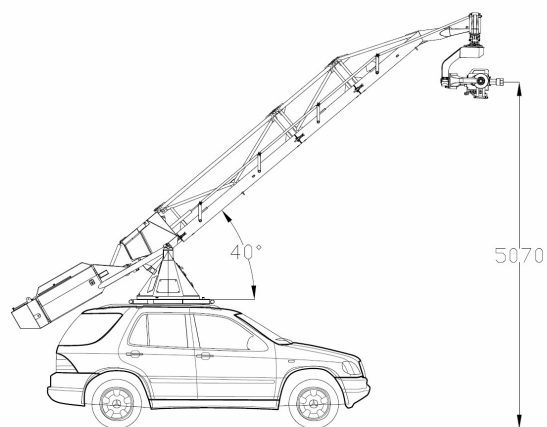

CONFIGURACION 4

6,45 MTS 21FT 2"

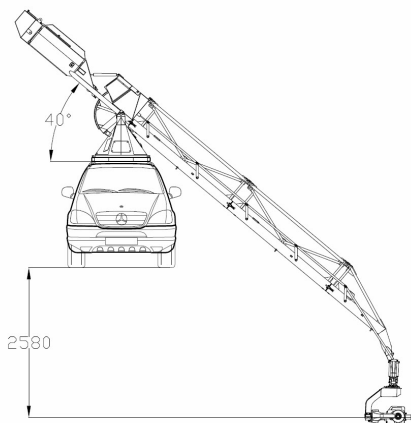
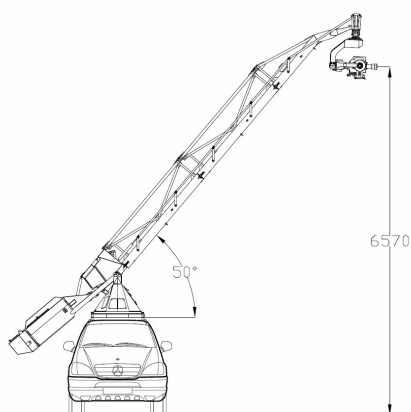
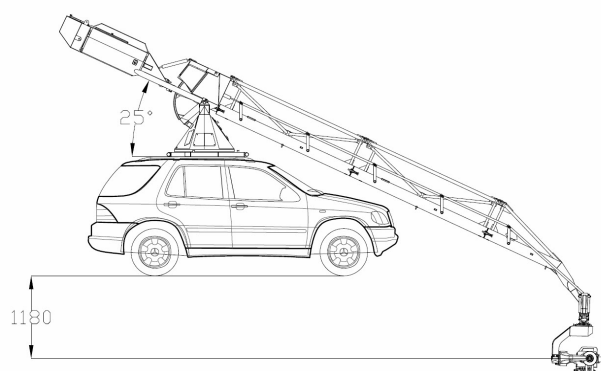
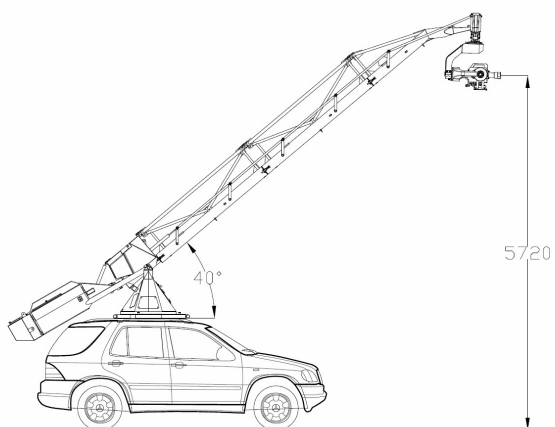

CONFIGURACION 5

7,55 MTS 26 FT 2"

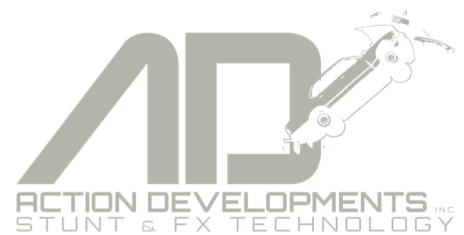
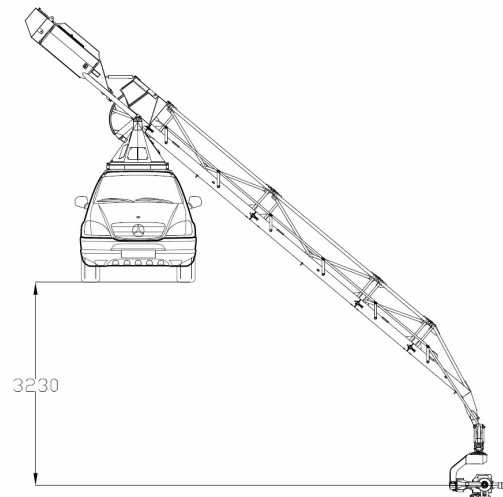
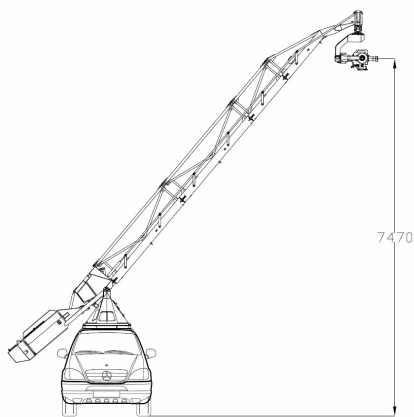
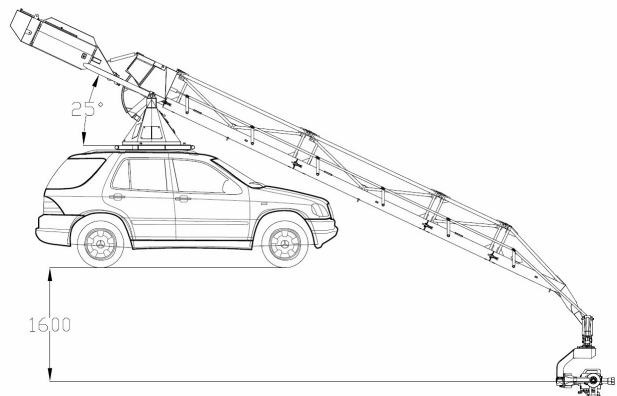
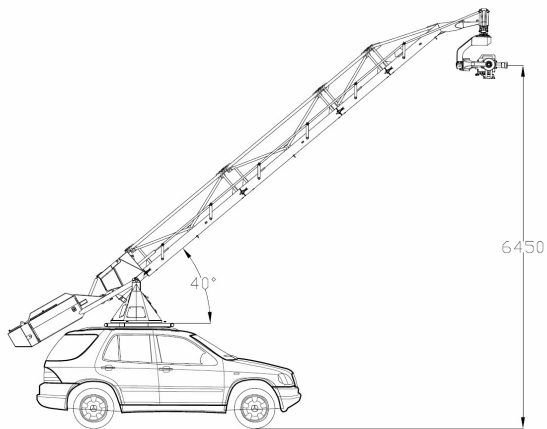

BLACKUNICORN EUROPE PH: +34662546714
CONTACT@BLACKUNICORNEEUROPE.COM
ACTION DEVELOPMENTS INC.
ACTION & STUNT TECHNOLOGY
MADRID SPAIN

